

# CROWN LINK®

專業薄膜開關連接器第一品牌

ROHS

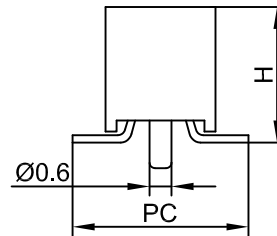
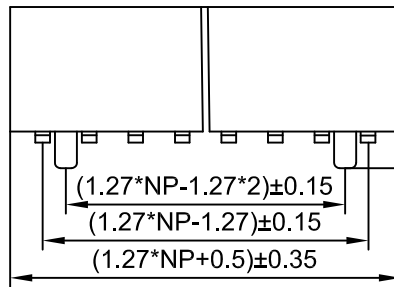
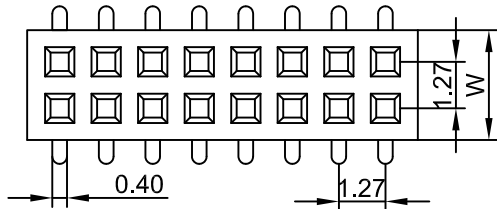
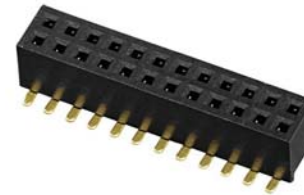

### ◆ Specifications

- 1. Current Rating: 1Amps
- 2. Insulator Resistance: 1000 Megohms min
- 3. Dielectric withstanding Voltage: AC 500V
- 4. Operating Temperature: -25 °C to +85 °C
- 5. Contact Material: Phosphor bronze
- 6. Insulator Material: As follows
- 7. Plated: As follows

### ◆ PART NO.

L304 XX -XX 2 X X XX X

1.27mm double row	PLASTIC HEIGHT HW	PIN NO. 01~50	0=180° 1=90°	MATERIAL	PLATED	SERIES NO.	PACKAGE	
20=2.0*3.0	2=SMT	3= NY6T	4= LCP	5= NY66	7= NY46	8= NY9T	01~69: Without a column 70~89: With inside column 90~99: With outside column	A=bag B=tubes C=tray D=reel
34=3.4*3.0								
43=4.3*3.0								

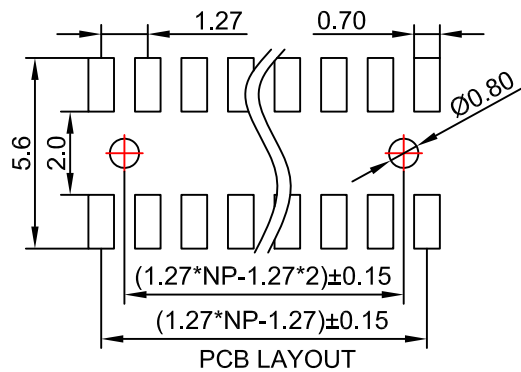

PCB LAYOUT

				LINER	ANGLES
				.0 ±0.3	0.° ±2.0°
A	FIRST DRAWING	MARY	2017.08.21	.00 ±0.2	.0° ±1.0°
REV/版本	MODIFIED CONTENT /變更內容	DRAWN/繪圖	DATE/日期	.000 ±0.1	.00° ±0.5°
				TOLERANCE RANGE/公差範圍	

DRAWN/繪圖	DATE/日期
MARY	2017.08.21
CHECK BY/審查	DATE/日期
VIVIAN	2017.08.21
APPROVED BY/核准	DATE/日期
WENDY	2017.08.21
PACKAGE/包裝	

<b>THE LEADING MANUFACTURER OF FPC &amp; FFC CONNECTOR, HOUSING AND DOME.</b>				
PRODUCT NAME/品名				
PH1.27*H 2XNP SMT DOUBLE ROW FEMALE HEADER TYPE-U WITH INSIDE COLUMN				
PART NO./料號	PIN NUMBER/針數	SCALE/比例	SIZE/圖號	UNIT/單位
L304XX-XX2XXXXX	02-100P		A4	mm
MATERIAL/材質	COLOR/顏色	ANGLE OF VIEW/視角	SHEET/頁碼	REV/版本
	BLACK COLOR		1 OF 1	A